

SOPHIA UNIVERSITY



Exchange Program



01

Japan's Pioneer in Global Education

Over 1,500 international students are studying at Sophia University from around the world. Since Sophia has a compact footprint that brings together all faculties and schools on a single campus, the campus functions as a microcosm of global society.

02

Wide Variety of Programs

Sophia University has offered English-medium programs for more than 60 years. Students can study business and economics, science and technology, and environmental studies, all strengths of Japan, in English. Sophia also provides a wide variety of Japanese courses for international students.

03

TOKYO, Japan

Sophia University is centrally located in megacity "Tokyo", a political and economic hub that affords an invaluable opportunity to experience a unique culture in which traditional and modern elements intermingle.



English Taught Undergraduate Programs



Faculty of Liberal Arts

http://www.sophia.ac.jp/eng/program/undergraduate_c/UG_LA

Centered around courses in Comparative Culture, International Business and Economics, and Social Studies, the broad interdisciplinary curriculum of the Faculty of Liberal Arts (FLA) is designed to extend the general knowledge of students while developing their critical thinking ability. A wide range of courses that are focused on Japan help students gain an understanding of both present-day Japan and its traditions in a global context.

Faculty of Science and Technology

<http://www.st.sophia.ac.jp/english/about-us/index.html>

Green Science The Green Science program is designed to provide a fundamental knowledge of substances, and to resolve environmental issues at the atomic and molecular levels based on green material sciences.

Green Engineering The Green Engineering program is designed to provide electrical and mechanical engineering skills that will lead to the further development of energy-conservation technologies, efficient power generation, transmission and distribution.



English Taught Graduate Programs

Global Studies

<http://gpgs.fl.sophia.ac.jp/>

The Graduate Program in Global Studies emphasizes inquiry into the contemporary world and its historical antecedents by combining the interdisciplinary themes of global studies, theories and the methods of academic disciplines, and cross-cultural understandings of Japanese and area studies. It has three MA degrees—Global Studies, International Business and Development Studies, and Japanese Studies—each with its own specialized curriculum. Graduate exchange students are welcome to take content courses that are consistent with their graduate degree and for which they have sufficient background.

Global Environmental Studies

<http://www.genv.sophia.ac.jp/english/index.html>

The curriculum covers three fields: Economics and Business Administration for the Environment, Law and Policies, and Sociology for the Environment and Science and Engineering for the Environment. One of the strategies of this course is to enhance the capacity of students to contribute to the solving of current environmental issues by offering them a wide variety of practical and discipline-specific programs.

Green Science and Engineering

<http://www.st.sophia.ac.jp/english/graduate-studies/index.html>

Green Science and Engineering places an emphasis on environment- and sustainability-related studies, which are of paramount importance to the future of mankind. To foster cross-disciplinary education, faculty members drawn from all the other eight divisions are involved in the teaching. Students are expected to associate with a faculty member and join her/his research group to pursue the advanced education required for thesis research.

Linguistics <TESOL>

Program in Linguistics (TESOL) provides courses with an emphasis on both theory and practice. The faculty members represent a diverse spectrum of applied linguistics and language education, ensuring a comprehensive program for all who are interested in teaching English as a second or foreign language.



日本語受け入れプログラム -Programs taught in Japanese-

学部： 神学部、文学部、総合人間科学部、法学部、経済学部、外国語学部、総合グローバル学部、理工学部
 研究科： 神学研究科、実践宗教学研究科、哲学研究科、文学研究科、総合人間科学研究科、法学研究科、
 経済学研究科、言語科学研究科、理工学研究科、地球環境学研究科
 詳細は本学HPをご参照ください。 <https://www.sophia.ac.jp/jpn/program/index.html>



Japanese Language Program

Offered by the Center for Language Education and Research, Sophia provides multiple tracks and levels of Japanese language courses according to students' needs and linguistic backgrounds. Students who have prior Japanese study experience will be placed to appropriate class level according to the result of Japanese placement test.

<http://www.sophia-cler.jp/study/ja/>

Regular Track

The regular track offers beginning, intermediate to advanced courses where 90-minute classes meet four or five times per week. This track aims to focus on developing communicative competence through extensive practices by integrating four skills, listening, speaking, reading and writing. English is occasionally used for instruction as necessary.

Intensive Track

This track, which offers four-level intensive courses at beginning, intermediate, and advanced levels, is designed for students whose main purpose of coming to Japan is to mainly study Japanese. Fifteen hours of class time per week allow students to spend sufficient time to gain the high level of Japanese proficiency. English is occasionally used for instruction as necessary.

Specialized Japanese Courses

Students at an advanced level can take business Japanese and translation courses in order to prepare for their future career. Academic Japanese courses are also available for students who require the high level of academic skills in order to enroll in undergraduate and graduate courses in specialized disciplines.

General Course Information

http://www.sophia.ac.jp/eng/admissions/exchangeprograms/course_info

Exchange students must register for the equivalent of at least 10 hours of instruction per week.

Exchange students should choose most courses from the departments/graduate program that he/she enrolled in.

Courses NOT open to exchange students:

FLA core programs, FST laboratory classes, GPGS compulsory courses, foreign language courses (except Japanese language), seminar and Studies in Christian Humanism

Standard Course Load

Regular Japanese track + 2-4 lecture classes

Intensive Japanese track + 1-3 lecture classes

Application requirements

Programs taught in English

TOEFL iBT 79, TOEFL ITP 550, IELTS 6.0, or TOEIC730

only for Graduate Program of Global Studies

TOEFL iBT 100, TOEFL ITP 600, IELTS 7.0, or TOEIC870

Programs taught in Japanese

Level N1 of the Japanese Language Proficiency Test

ALL applicants are strongly expected to have a Grade Point Average of B (3.0) or above in the standard 4-level rating system (A, B, C, D) or equivalent.

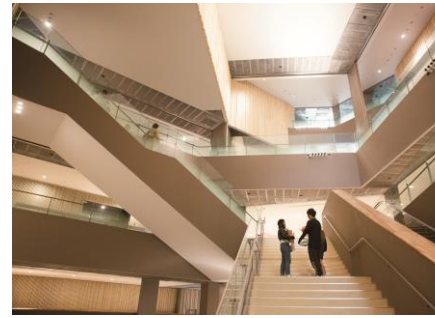

Academic Calendar

	Autumn Semester	Spring Semester
Arrival Date and Orientation	Mid-September	Early April
Classes	Mid-September – Late January	Mid-April – Late July
Final Exams	Late January	Late July
Transcript Issuance	Late March	Mid-September
Application Deadline	April 10	November 10

Housing Information

https://www.sophia.ac.jp/eng/admissions/exchangeprograms/housingInfo_costs/index.html

Approximate Accommodation Expenses

Type of Housing (off campus only)	1 semester (4 months) - 1 year (10 months)
Sophia Soshigaya International House	220,000 - 590,000 yen
Sophia-Arrupe International Residence	470,000 - 1,050,000 yen
Kasai International House for Women	320,000 - 750,000 yen
Wakeijuku for Men	500,000 - 1,200,000 yen
Azalea House	300,000 - 650,000 yen
FlatShare SHIN-Otsuka Campus	400,000 - 800,000 yen
DK House Tokyo Nerima	320,000 - 710,000 yen
DK House Shinkoiwa	320,000 - 710,000 yen
DK House Matsudo	290,000 - 630,000 yen
Social Residence Higashikoganei	320,000 - 750,000 yen



Campus Location : Yotsuya, Tokyo

The campus is centrally located within walking distance of the National Diet and the nation's administrative district, the Imperial Palace, the National Guest House, and many other places of interest. Shinjuku, one of the most exciting areas in Tokyo, is just a 5 minutes train ride away from Yotsuya, the closest station.

Contact Information

Center for Global Education and Discovery
Sophia University
7-1 Kioi-cho Chiyoda-ku, Tokyo 102-8554 Japan
Phone: 81-3-3238-3521 Email: inbound-co@sophia.ac.jp
<http://www.sophia.ac.jp/eng/admissions/exchangeprograms>

